

HWB Series

Hydraulic Drive – Triplex Plunger Pump

FEATURES

- Innovative drive design eliminates need for auxiliary hydraulic drive
- Forged brass manifold
- Built-in Pump Thermal Protection
- No scheduled maintenance required
- Longer life low and high pressure seals
- Pressure trapping unloader included

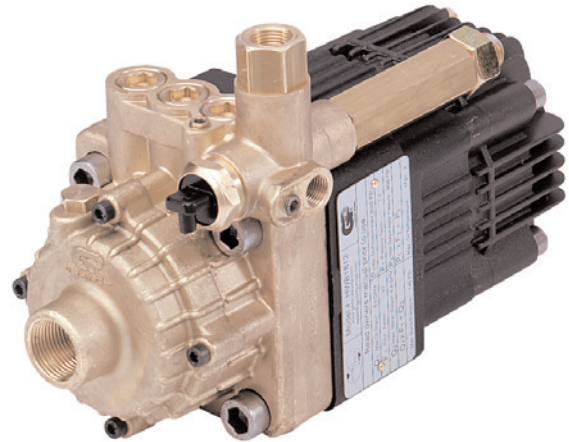

SPECIFICATIONS

Pump Model	HWB2512	HWB2112	HWB1812	HWB1512
Max. Discharge Volume	8.6 GPM	6.6 GPM	4.4 GPM	3.3 GPM
Max. Discharge Pressure	2175 PSI	2900 PSI	3625 PSI	4350 PSI
Maximum Fluid Temp.	145°F			
Minimum Inlet Pressure	-9 ft.			
Maximum Inlet Pressure	150 PSI			
Inlet Port Thread	3/4" NPT-F			
Discharge Port Thread	3/8" NPT-F			
Flow Factor	1.3	1.0	0.67	0.5
Pressure Factor	0.6	0.8	1.2	1.75
Max. Hydraulic Pressure	3625	3625	3020	2485
Max. Oil Supply Volume	6.6 GPM			
Minimum Oil Supply	3.2 GPM			
Max. Hyd. Return Press.	145 PSI			
Max. Oil Temperature	176° F			
Hydraulic Inlet Port Size	1/2" BSPP-F			
Hydraulic Return Port Size	1/2" BSPP-F			
Weight	19 lbs.			
Dimensions	11.2 x 4.7 x 7.0 in.			

PERFORMANCE

Flow Conversion Chart

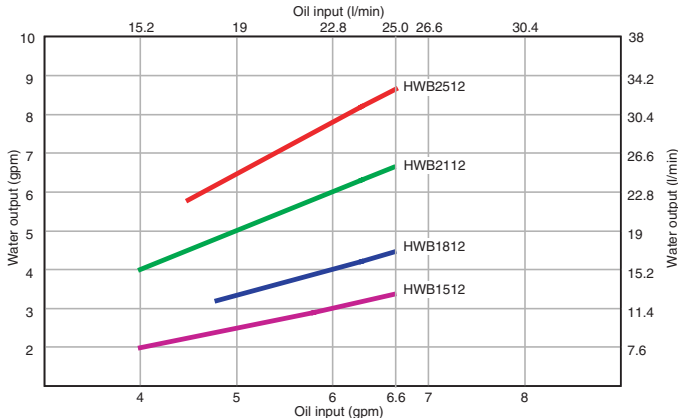

Pressure Conversion Chart

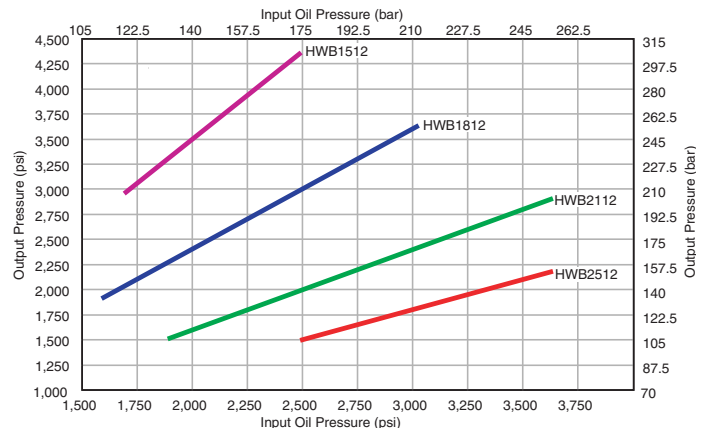

HWB Series

GENERAL PUMP A member of the Interpump Group

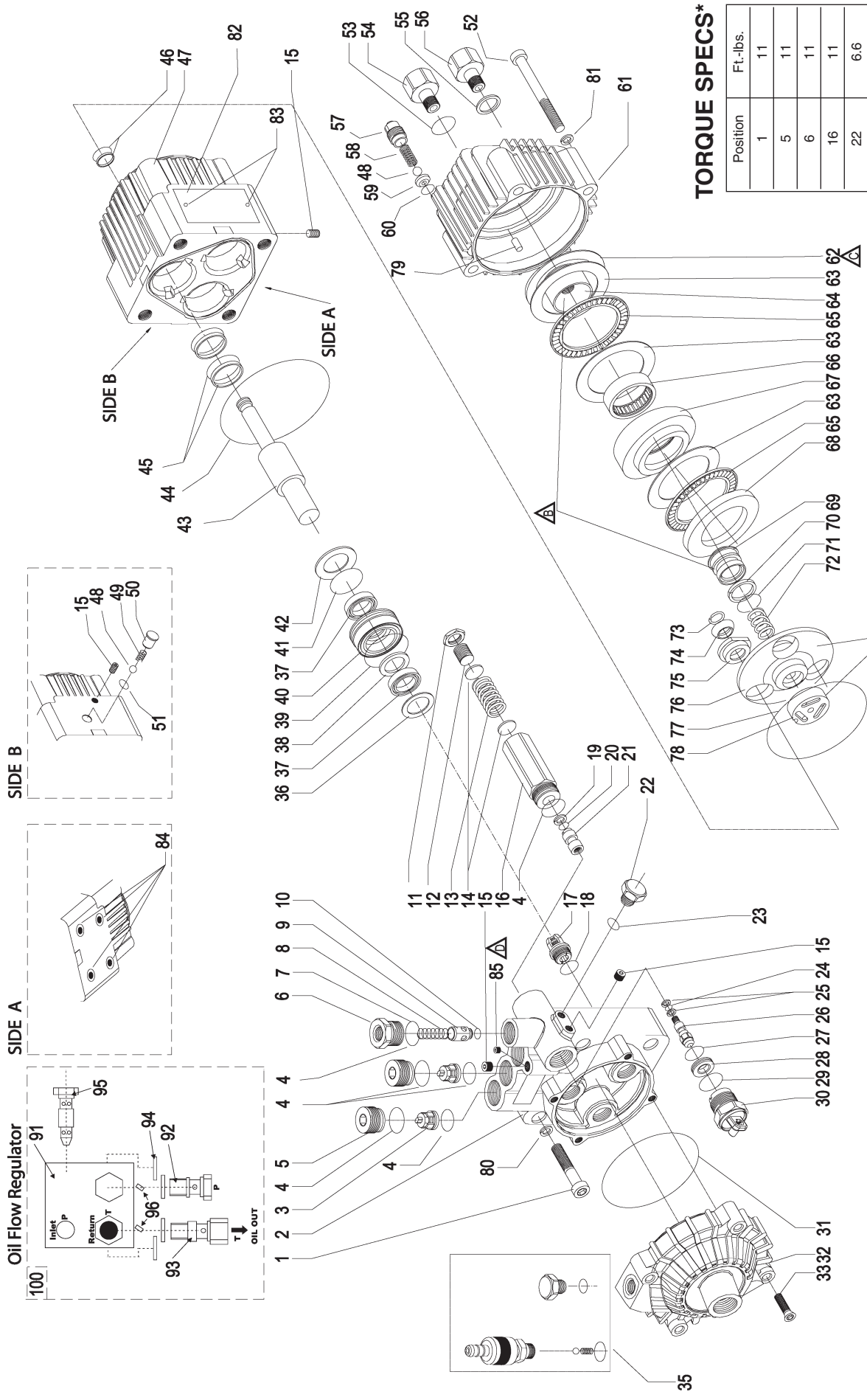

TORQUE SPECS*

Position	Ft.-lbs.
1	1.1
5	1.1
6	1.1
16	1.1
22	6.6
33	6.6
35	6.6
52	7.7

- A. Order kit P320. To guarantee proper performance, parts are factory-mated and must be replaced as a set.
- B. Order kit P330. To guarantee proper performance, parts are factory-mated and must be replaced as a set.
- C. Drive must be properly shimmed after disassembly. An authorized technician must perform shimming operation. Failure to shim drive correctly will result in premature wear and/or failure. Improper shimming will void warranty.
- D. Orifice (ref. 85) is only present in HWB1512 and HWB1812 models. No service required. Specify pump model when ordering replacement manifold (ref. 2).

*Decrease torque by 20% if threads are lubricated.

