

Exploded View - P300 Series

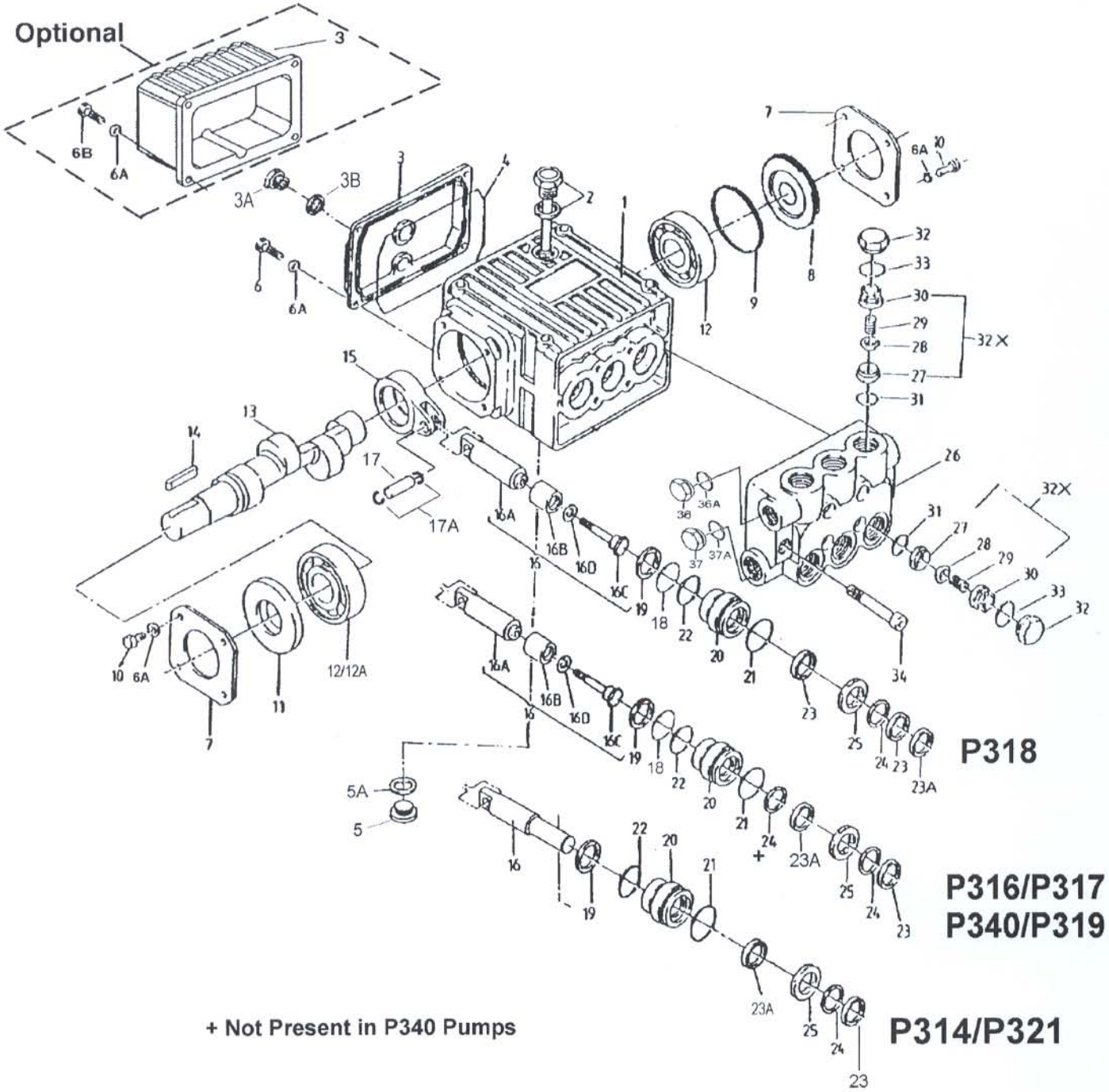

P318

**P316/P317
P340/P319**

+ Not Present in P340 Pumps

P314/P321

P300 SERIES PARTS LIST

| A = P321 | | B = P314 | | C = P316 | | D = P317 | | E = P318 | | F = P340 | | G = P319 | | | |
|-------------|----------------|--|-------------|-------------|----------------|-------------------------------|-------------|-------------|----------------|--------------------|-------------|-------------|----------------|--------------------|-------------|
| <u>ITEM</u> | <u>PARTNO.</u> | <u>DESCRIPTION</u> | <u>QTY.</u> | <u>ITEM</u> | <u>PARTNO.</u> | <u>DESCRIPTION</u> | <u>QTY.</u> | <u>ITEM</u> | <u>PARTNO.</u> | <u>DESCRIPTION</u> | <u>QTY.</u> | <u>ITEM</u> | <u>PARTNO.</u> | <u>DESCRIPTION</u> | <u>QTY.</u> |
| 1 | 08326 | Crankcase | 1 | 17A | 22723 | Clip Ring | 6 | | | | | | | | |
| 2 | 06773 | Dipstick Assembly | 1 | 18 | 07770 | O-Ring (C, D, E, F, G) | 3 | | | | | | | | |
| 3 | 08410B | Crankcase Cover, Short | 1 | 19 | 08356-0010 | Oil Seal | 3 | | | | | | | | |
| 3 | 08410-LG | Crankcase Cover, Extended | 1 | 20 | 08414 | Seal Case (A, B) | 3 | | | | | | | | |
| 3A | 07190 | Oil Drain Plug | 1 | 20 | 08458 | Seal Case (C, D, G) | 3 | | | | | | | | |
| 3B | 13262 | Gasket for Plug | 1 | 20 | 08357 | Seal Case (E) | 3 | | | | | | | | |
| 4 | 08328 | O-Ring | 1 | 20 | 06543 | Seal Case (F) | 3 | | | | | | | | |
| 5 | 06273 | Oil Drain Plug | 1 | 21 | 07234 | O-Ring (A, B) | 3 | | | | | | | | |
| 5A | 08192 | Gasket | 1 | 21 | 07780 | O-Ring (C, D, E, F, G) | 3 | | | | | | | | |
| 6 | 07188 | Screw, Short Cover | 4 | 22 | 12027 | O-Ring | 3 | | | | | | | | |
| 6A | 01176-2 | Spring Washer | 12 | 23 | 07391 | Grooved Seal Ring (A, B) | 3 | | | | | | | | |
| 6B | 01196 | Screw, Long Cover | 4 | 23 | 08477 | V-Sleeve (C, D, G) | 3 | | | | | | | | |
| 7 | 08303 | Bearing Cover I (A, B, G) | 1 | 23 | 08358 | Grooved Seal (E), Black | 6 | | | | | | | | |
| 7 | 08303 | Bearing Cover I (C, D, E, F) | 2 | 23 | 07767 | Grooved Seal (F) | 3 | | | | | | | | |
| 8 | 08330 | Bearing Cover II (A, B, G) | 1 | 23A | 08598 | Grooved Seal (A, B) | 3 | | | | | | | | |
| 8 | 08491 | Sight Glass (C, D, E, F) | 1 | 23A | 08087 | Grooved Seal (C, D, G), Brown | 3 | | | | | | | | |
| 9 | 07193 | O-Ring | 1 | 23A | 08359 | Spacer (E) | 3 | | | | | | | | |
| 10 | 07225 | Screw with Lock Washer | 8 | 23A | 06315 | Grooved Seal (F) | 3 | | | | | | | | |
| 11 | 08331 | Radial Shaft Seal | 1 | 24 | 07392 | Pressure Ring (A, B) | 3 | | | | | | | | |
| 12 | 01086 | Ball Bearing (A, C, D, E, G) | 2 | 24 | 07904 | Pressure Ring (C, D, G) | 6 | | | | | | | | |
| 12 | 01086 | Ball Bearing (B, F) | 1 | 24 | 08346 | Pressure Ring (E) | 3 | | | | | | | | |
| 12A | 07760 | Roller Bearing (B, F) | 1 | 24 | 07768 | Pressure Ring (F) | 3 | | | | | | | | |
| 13 | 06712 | Crankshaft (A, B, C, F) | 1 | 25 | 08417 | Weep Return Ring (A, B) | 3 | | | | | | | | |
| 13 | 08478 | Crankshaft (D) | 1 | 25 | 08337 | Weep Return Ring (C, D, G) | 3 | | | | | | | | |
| 13 | 08340 | Crankshaft (E) | 1 | 25 | 08361 | Weep Return Ring (E) | 3 | | | | | | | | |
| 13 | 06508 | Crankshaft (G) | 1 | 25 | 06544 | Weep Return Ring (F) | 3 | | | | | | | | |
| 14 | 06207 | Straight Key | 1 | 26 | 06556 | Valve Casing (A, B) | 1 | | | | | | | | |
| 15 | 08333 | Connecting Rod | 3 | 26 | 06349* | Valve Casing (C, D, G) | 1 | | | | | | | | |
| 16 | 08413 | Plunger Assembly Complete, 12mm (A,B) | 3 | 26 | 06413* | Valve Casing (E) | 1 | | | | | | | | |
| 16 | 08453 | Plunger Assembly Complete, 18mm (C,D,G) | 3 | 26 | 06545 | Valve Casing (F) | 1 | | | | | | | | |
| 16 | 08452 | Plunger Assembly Complete, 20mm (E) | 3 | 27 | 07849 | Valve Seat | 6 | | | | | | | | |
| 16 | 08452 | Plunger Assembly Complete, 20mm (E) | 3 | 28 | 07491 | Valve Plate | 6 | | | | | | | | |
| 16 | 08452 | Plunger Assembly Complete, 20mm (E) | 3 | 29 | 07906 | Valve Spring | 6 | | | | | | | | |
| 16 | 08452 | Plunger Assembly Complete, 20mm (E) | 3 | 30 | 07907 | Valve Spring Retainer | 6 | | | | | | | | |
| 16 | 06540 | Plunger Assembly, 16mm (F) | 3 | 31 | 07853 | O-Ring | 6 | | | | | | | | |
| 16A | 08367 | Plunger Base (C, D, E, F, G) | 3 | 32 | 06350* | Valve Plug (C, D, E, G) | 6 | | | | | | | | |
| 16B | 08455 | Plunger Pipe (C, D, G) | 3 | 32 | 06546 | Valve Plug (A, B, F) | 6 | | | | | | | | |
| 16B | 08449 | Plunger Pipe (E) | 3 | 32X | 07946 | Valve Assembly, Complete | 6 | | | | | | | | |
| 16B | 06541 | Plunger Pipe (F) | 3 | 33 | 07913 | O-Ring | 6 | | | | | | | | |
| 16C | 08456 | Tension Screw (C, D, F, G) | 3 | 34 | 08363 | Hex Head Cap Screw | 6 | | | | | | | | |
| 16C | 08450 | Inner Hex Screw (E) | 3 | 36 | 13338 | Plug, 3/8" BSP | 1 | | | | | | | | |
| 16D | 07676 | Copper Washer (C, D, F, G) | 3 | 36A | 08486 | Copper Crush Washer, 3/8" | 1 | | | | | | | | |
| 16D | 08451 | Copper Washer (E) | 3 | 37 | 07109 | Plug, 1/2" BSP | 1 | | | | | | | | |
| 17 | 06542 | Wrist Pin | 3 | 37A | 07661 | Seal | 1 | | | | | | | | |

*For P316/P317 pumps manufactured prior to 5/98, Item 26=08459 & Item 32=07928; for P318 pumps manufactured prior to 5/98, Item 26=08362 & Item 32=07928