



PORTABLE CABLE STORAGE REELS

For fast rollout and storage.

- Broadcast and pro-audio applications. The reels are stackable and have side mounted connector panels.
- Features optional heavy-duty, locking caster wheels (set includes 2 locking and 2 non-locking casters)
- Rugged steel and aluminum construction throughout. Square tubing frame.
- Black, non-reflective matte finish.
- Removable side panel (blank panel is supplied as standard)
- Standard strain relief inside panel compartment.
- Frame clips allow stacking.
- Optional pull handle is available for AV-2 and AV-3 (p/n 9949.0500), see pg 3.
- Adjustable Cam-lock drag brake.



Cam-lock shown on AV-2



AV-1
Standard with Caster
Mounting Plates



AV-3
shown with
Optional Casters

AV-2
shown with
Optional Casters
(cable and punched
end plate not
included)

Parts Drawing – AV-1 - ISO 190, AV-2 - ISO 191, AV-3 - ISO 231

Model Number	Cable Capacity of Reel <div>feet</div> <div>m.</div>									Approx. Weight without cable <div>lb.</div> <div>kg.</div>			Reel Dimensions <div>inches</div> <div>mm.</div>							
	O.D. (in.) O.D. (mm)	.25 6	.32 8	.38 10	.41 10	.45 11	.49 12	.53 15	.67 17	NET	UPS/ FedEx SHIP Wt.	Freight SHIP Wt.	A	B	C	D	E	F	G	H
AV-1		600 183	350 107	225 69	200 61	150 46	125 38	—	—	14 6	58* 26	21 10	10.5 267	7 178	6 152	13.75 349	11.75 298	14.25 362	14.25 362	7 178
AV-2		— —	— —	— 229	750 183	600 152	500 107	350 76	250 76	25 11	80* 36	30 14	13 330	9 229	8 203	20 508	18 457	16.25 413	20.5 521	10 254
AV-3		— 213	700 137	450 114	375 99	325 84	275 71	175 53	—	18 8	58* 26	23 10	12.82 326	7 178	6 152	16 406	15 381	13.5 343	16.88 429	7.88 200

Notes:

Specifications subject to change.

1. Be sure to check dimensions and weights prior to ordering.

2. Casters will add 2 3/4" to G dimension on AV-1 and AV-3.

Castors will add 3 1/2" to G dimension on AV-2.

*Dimensional weight applies when shipped as a parcel package (via FedEx or UPS Ground)

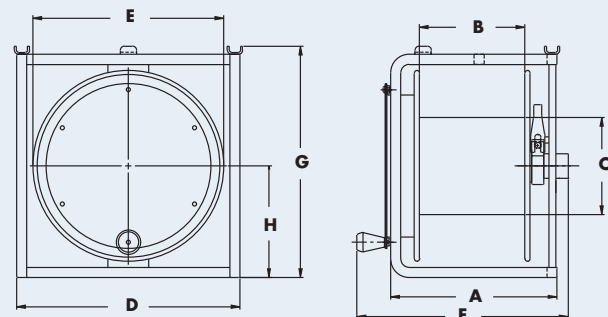

AV-1, AV-2 and AV-3