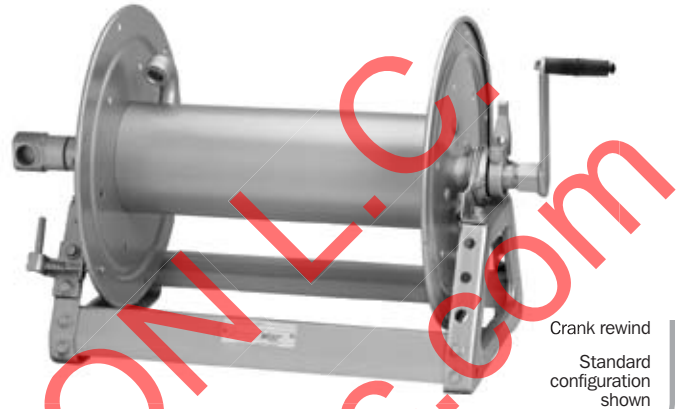

Series **1800**

• Air Compressors • Washdown

**To handle single 5/8" or 3/4" I.D. hose.**

- Lightweight, compact reels designed for long lengths of hose in manual and power rewind.
- Direct crank rewind is permanently attached.
- Chain and sprocket drive powered by electric, hydraulic or compressed air motor.
- Manual reels include cam-lock drag brake, spring actuated pin lock.
- Standard inlet: 90° ball bearing swivel joint, 1" female NPT threads.
- Standard outlet: 3/4" female NPT threads.
- Optional rollers: Specify roller position when ordering.
- Standard pressures to 2000 psi (138 bar), available up to 4000 psi (276 bar) – must specify.
- Temperatures from -40°F to +250°F (-40°C to +121°C).

Crank rewind  
Standard  
configuration  
shown**Optional External Mounting Brackets**

Part No. 9906.0027.

Add 2-1/2" to the X dimensions shown in the chart.

**PARTS DRAWING – ISO 136 (POWER); ISO 180 (MANUAL)**

Model Number  For power rewind see Note 5	Hose Capacity of Reel feet m			Approx. Weight Crank Rewind lb. kg  see Note 3			Reel Dimensions*** in. mm						
	I.D. in. mm	5/8 16	3/4 19	NET	UPS/ FedEx SHIP Wt.	Freight SHIP Wt.	A	B	E CRANK	E POWER	F CRANK	F POWER	X
	O.D. in. mm	1 25	1-9/32 40										
1816-17-18	75	50	28	80*	63	13	8	16.5	19	23.38	18.5	11.5	
	23	15	13	36	29	330	203	419	483	594	470	292	
1822-17-18	150	100	30	98*	65	19	14	16.5	19	29.38	24.5	17.5	
	46	30	14	45	29	483	356	419	483	746	622	445	
1826-17-18	200	125	32	98*	67	23	18	16.5	19	33.38	28.5	21.5	
	61	38	15	45	30	584	457	419	483	848	724	546	
1830-17-18	250	150	33	110*	68	27	22	16.5	19	37.38	32.5	25.5	
	76	46	15	50	31	686	559	419	483	950	826	648	
1836-17-18	300	200	36	129*	71	33	28	16.5	19	43.38	38.5	31.5	
	91	61	16	59	32	838	711	419	483	1102	978	800	

**Notes:**

1. Specifications subject to change.
2. Upon request, reels can be supplied with drum lengths other than shown.
3. Weights shown in chart are for crank rewind models. ADD these amounts for power rewind models (does not apply to FedEx or UPS):

	Net lbs/kg	Ship lbs/kg
Electric	18/8.2	18/8.2
Hydraulic	15/6.8	15/6.8
Air	15/6.8	15/6.8

4. Dimension "F" is the overall length of standard model reels.
5. When ordering power rewind models, prefix model number with:
  - A = Air Rewind
  - E = Electric Rewind
  - HD = Hydraulic Rewind

(Air rewind reels are supplied with control valve and 18" air hose; 12v and 24v DC rewind reels are supplied with switch and solenoid; 115v AC rewind reels are not supplied with switch but can be ordered separately; hydraulic rewind reels are not supplied with control valve.)

6. Manual rewind available in RT or LB configurations only.
7. Finish: Refer to page 3.
8. Be sure to check dimensions and weights prior to ordering.
9. Some roller options may prohibit the use of our molded chain guard.

**NOTICE:** A flexible connector must be used between the inlet pipe and the inlet swivel joint.  
\* Dimensional weight applies when shipped as a parcel package (via FedEx or UPS Ground).

\*\*\* X, Y indicate mounting holes. See page 5.

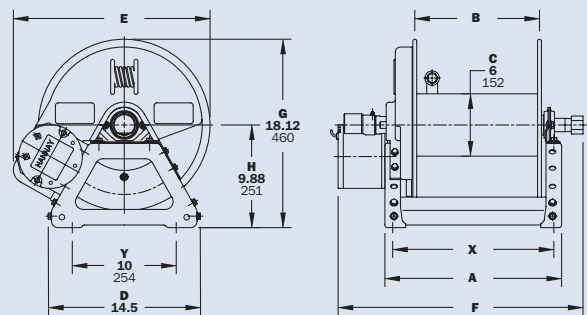

Power rewind shown